

# Ecrusor™

## Depackaging System

### Transforming Waste to Resource

## Solution for depackaging and preparing biodegradable wastes for energy generation

### The Process

Ecrusor™ is the ideal solution to turn food waste and other wastes high in caloric value into useful energy. A compact and robust process, Ecrusor depacks food waste from its packaging in order to extract the organic material. Inert waste packaging material is sent one direction; energy-rich organic material is macerated and sent another. The patented process creates a homogenous mixture of liquid and solid organics that can then be conveyed to an anaerobic digester to produce biogas. Using CHP or other tools, this biogas can then be converted into energy for use at the facility or for sale back to the grid. Ecrusor thus helps turn waste treatment facilities into revenue-generating resource recovery facilities in a circular economy approach.

### Simple Operation

Packaged or unpackaged waste is dumped into Ecrusor's receiving hopper. In Ecrusor, the bulk packaged waste is first broken apart, separating inorganic waste from the organic material. This is done with spiral grinding screws that move forwards and backwards, agitating, distributing, and breaking apart the waste. Ecrusor has an end plate that is equipped with a number of chopping/cutting teeth which facilitate the destruction of the inert packaging material without making it so small that it could pass through the effluent perforated plates. The perforated plates thus retain the inert material but allow the pureed organic material to pass on to digestion.

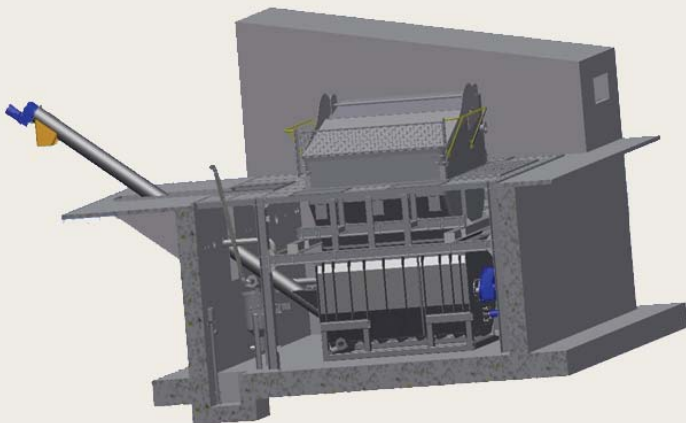

## Performance

Two perforated plates located below the grinding screws separate the organic and inorganic material. The grinding screws puree the organic material, allowing for the organics to pass through the perforated plate to three collection screws that convey the organic slurry out of the unit. The unusable inert packaging waste remains on the perforated plates and is removed with an extraction screw. Residual organic matter on the packaging material is washed off as it moves up and out of the extraction screw. The washed inert waste is then collected in a waste container to be transported off-site.

Once separated, the organic slurry is pumped to the plant's anaerobic digesters for digestion and generation of biogas and energy.

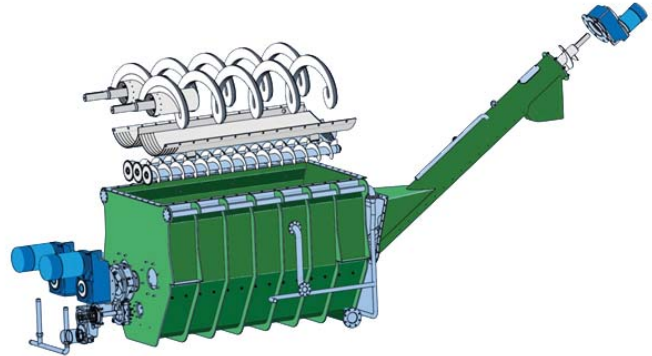

## Advantages

- Ecrusor removes plastic, metal and mixed material packaging simultaneously
- Very low operating energy while producing a slurry that generates electricity
- Over 10 years of full-scale operation at multiple installations
- Installed below grade, outdoors or within truck off-loading stations to receive material directly from vehicles
- Ecrusor is capable of processing up to 52 cubic yards of waste every hour



Contact your local Veolia representative for more information:

**Veolia Water Technologies Canada**

4105 Sartelon - Saint-Laurent, QC H4S 2B3

Phone: 514-334-7230- Fax: 514-334-5070

[salescanada@veolia.com](mailto:salescanada@veolia.com)